

Boardwalk

Lobelia Road

LYDE GREEN

APPROXIMATE FLOOR AREA
50 SQM / 538 SQFT

BOOK A VIEWING

01174 532 985

hello@boardwalkpropertyco.com



GROUND FLOOR
268 sq.ft. (24.9 sq.m.) approx.

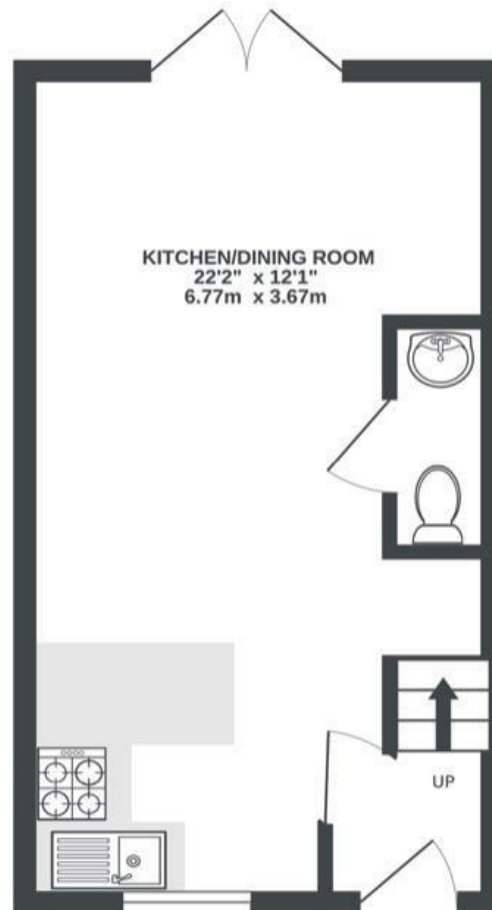

1ST FLOOR
270 sq.ft. (25.1 sq.m.) approx.

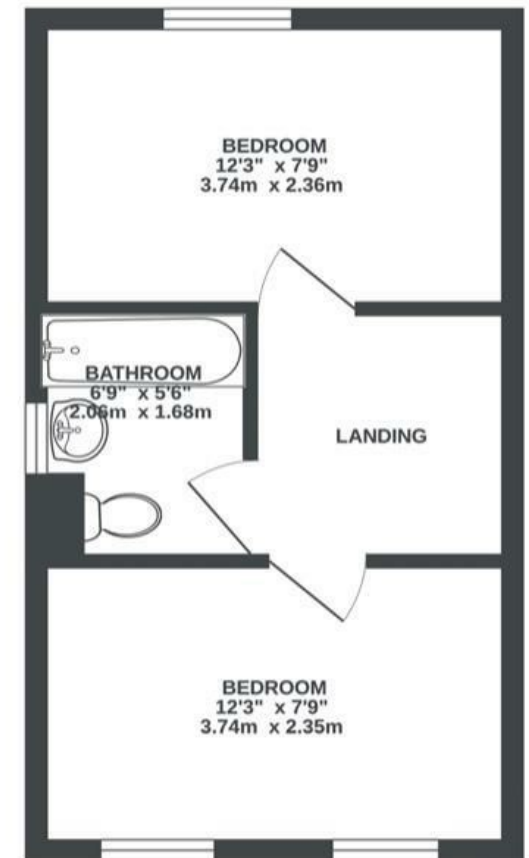

Illustrations are for reference purposes only, measurements are approximate, not to scale.

Boardwalk

Lobelia Road

EMERSONS GREEN, BRISTOL



£280,000



2 Bedrooms



Bristol, BS16



1 Bathrooms

7NF

"Lyde Green has been a wonderful, safe home for us for the last 4 years. We live in a quiet corner of the estate surrounded by lovely neighbours and easy access to transport links. Lyde Green offers lovely walks and parks nearby. Although we have not made use of the schools or nursery, we have heard great things from our neighbours. The community in Lyde Green is one of its greatest assets, we have used the local Facebook groups plentifully and everyone we have crossed paths with has been very warm and welcoming. Lyde Green offers a lot of amenities within walking distance, Sainsbury's Local and Screwfix being less than a 5 minute walk from our front door were a real highlight. We will be sad to be leaving Lyde Green and we can truly say it was a wonderful place to live."

